

It is for you to Dream and for us to Deliver...



# Ashiyana infinity





Actual Landscaped & Artistic Impression

a **Vision** for your  
**FUTURE**



Ashiyana Group is a leading developer based in Khopoli with an extensive portfolio of modern luxury residential and commercial properties across Khopoli's most sought-after locations. Our properties, through which we aim to enrich the lives of our residents and investors, cater to all lifestyles. We have successfully delivered thousands of homes with a customer centric approach for more than three decades now **Ashiyana Infinity**... a visionary concept by **Ashiyana Dream Homes Pvt Ltd**... combines the best of design perspective and a modern architecture to create the ideal place for the modern community living. **Ashiyana Infinity** comprises of 4 high-rise residential buildings, a mega integrated retail space, breathtaking views and lush greenery has become one of the most sought after and significant lifestyle destinations in the heart of Khopoli.

Host to Khopoli's first Reliance smart point **Ashiyana Infinity** immerses everyone with unparalleled convenience and opens the door for many more brands to be a part of its success story. **Ashiyana Infinity** invites its residents to feel at home and be a part of a diverse and multicultural community. Family-friendly outdoor activities, enough parking for everyone, leisure, dining and retail therapy is a slice of everyday life in here.

In more ways than one, Infinity is creating a new paradigm for community living in Khopoli.



Dream Homes Pvt. Ltd.

Exceeding your **Expectations**  
is our **Goal...**





Ashiyana  
infinity

New Landmark of  
**KHOPOLI**







Exceptional Property  
Exceptional Quality  
**CONSTRUCTION**



Living Room  
2.80X4.20  
9'3"X13'10"

Kitchen  
2.70X2.40  
8'11"X7'11"



Ashiyana  
infinity

Balcony  
1 M / 3'4" Wide

Wardrobe

Toilet  
2.0X1.2  
6'7"X4'0"

Bedroom  
3.00X3.12  
9'11"X10'4"

1 BHK Isometric View  
Artistic Impression



Actual Photograph of 1 BHK Show Flat  
in Building No. 1

The typical living room at Ashiyana infinity is immensely large and airy, incomparable to most other projects. Huge windows open up to gorgeous views of the city skyline.



Enormous kitchens with a massive amount of counter space. You'll find excess and comfort in every aspect of Ashiyana infinity.

# Ashiyana infinity

## Specifications

### Flooring

- 2x2 vitrified tiles flooring.

### Kitchen

- Beautiful decorative granite kitchen platform with ss sink and tiles upto window level just above the Kitchen Platform.
- Electrical point for Fridge, water purifier and Exhaust Fan in Kitchen.

### Bath & WC

- Coloured glazed tiles up to full height & good quality sanitary fitting.
- Concealed Plumbing with hot & cold mixer arrangement & premium quality plumbing fittings.
- Plumbing Provision for Geyser & Loft tank.

### Door

- Main door in teak wood frame, decorative laminate both side flush door with latch lock.
- W.C. & bath door will be in backlite sheet in with granite frame, internal doors both side laminate with granite door frame.

## Welcome to the WORLD of LOVE and COMFORT

### Window

- Powder coated Aluminium sliding windows with Single Fixed Mosquito Net Shutter in granite framing with m.s. flat grills.

### Wiring

- Copper wiring with Branded switches, TV point in living room, & inverter backup wiring.

### POP Work

- Gypsum finished wall in all rooms.

### Lift

- Reputed make lift. with power backup .

### Water Tank

- Under ground& overhead tank with adequate storage capacity for borewell & Municipal water.

### Terrace

- Special water proofing treatment.

### Color

- Tractor Emulsion Paint or similar for internal wall &
- Acrylic Emulsion paint for external walls.



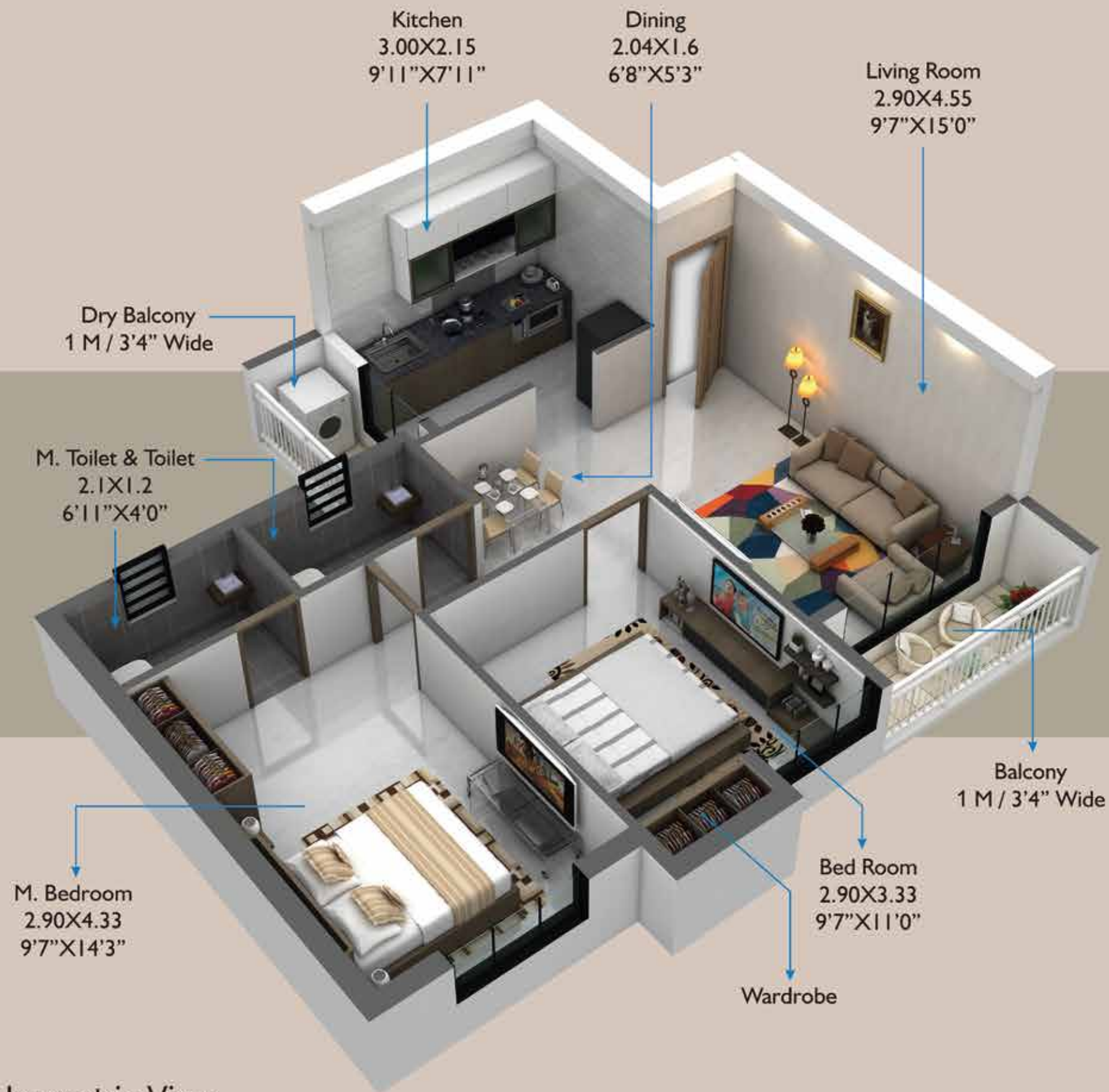

2 BHK Isometric View  
Artistic Impression



There is no match for the super-sized bedrooms at Ashiyana infinity. These massive bedrooms will spoil you with unparalleled comfort and panoramic views from huge floor-to-ceiling windows.



Actual Photograph of 1 BHK Show Flat  
in Building No. 1





## Project Features



On Grid Solar Power System for Lift & Common Areas



Jogging Track



CCTV Surveillance for Premises



Health Club



Landscaped Garden



Swimming Pool



Children Play Area



Space for Indoor Games



Space Outdoor Games for Children



Open Gym



Decorative Entrance Lobby



Power Back Up for Lift and common Lights

## Homes well Connected with Everything

That you may need for a Comfortable & Secured Life for example



### Hospitals

- Shree Parvati Hospital
- Jakhotia Nursing Homes
- Sumitra Raj Hospital
- Sanjivani Hospital
- Spandan Hospital



### Schools & Colleges

- Carmel Convent School
- St. Merry School
- Vishwaniketan's Institute
- J.C.M.M. School
- Shishu Mandir



### Shopping & Tourist Attraction

- Reliance Smart Point
- Susan Mall
- Imagica
- Khandala & Lonavala
- Zenith Waterfall



Artistic Impression

Ashiyana  
infinity





1. Building No. 1
2. Building No. 2
3. Building No. 3
4. Building No. 4
5. Swimming Pool

6. Kids Swimming Pool
7. Health Club
8. Garden & Sitting Area
9. Jogging Track
10. Kids Play Area & Open GYM

11. Outdoor Games for Children's
12. Bike Parking
13. Car Parking
14. Entry Gate & Security Cabin
15. Commercial Visitor's Parking



18 MTR. WIDE D.P. ROAD

18 MTR. WIDE D.P. ROAD





The project has been registered via  
Maha Rera Registration No.  
P52000017538  
P52000030015  
and is available on the website  
<https://maharera.mahaonline.gov.in>  
under registered projects.

Project By



**Ashiyana Dream Homes Pvt. Ltd.**

**Site Address :** Ashiyana Infinity, Old Mumbai - Pune Highway,  
Near Hanuman Mandir, Khopoli.

**Office Address :** 106 to 109, R. K. Tower, Bazarpeth,  
Khopoli - 410 203 ☎ 02192 - 267712

✉ : [admin@ashiyanadreamhomes.com](mailto:admin@ashiyanadreamhomes.com)

🌐 : [www.ashiyanadreamhomes.com](http://www.ashiyanadreamhomes.com)

**Call : +91 844 844 8714**

Architect  
**Abhikalpa I AAK Design Cell**

RCC Consultant  
**Adharshila Consultants**

Legal Advisor  
**Adv. Vijay M. Patankar**

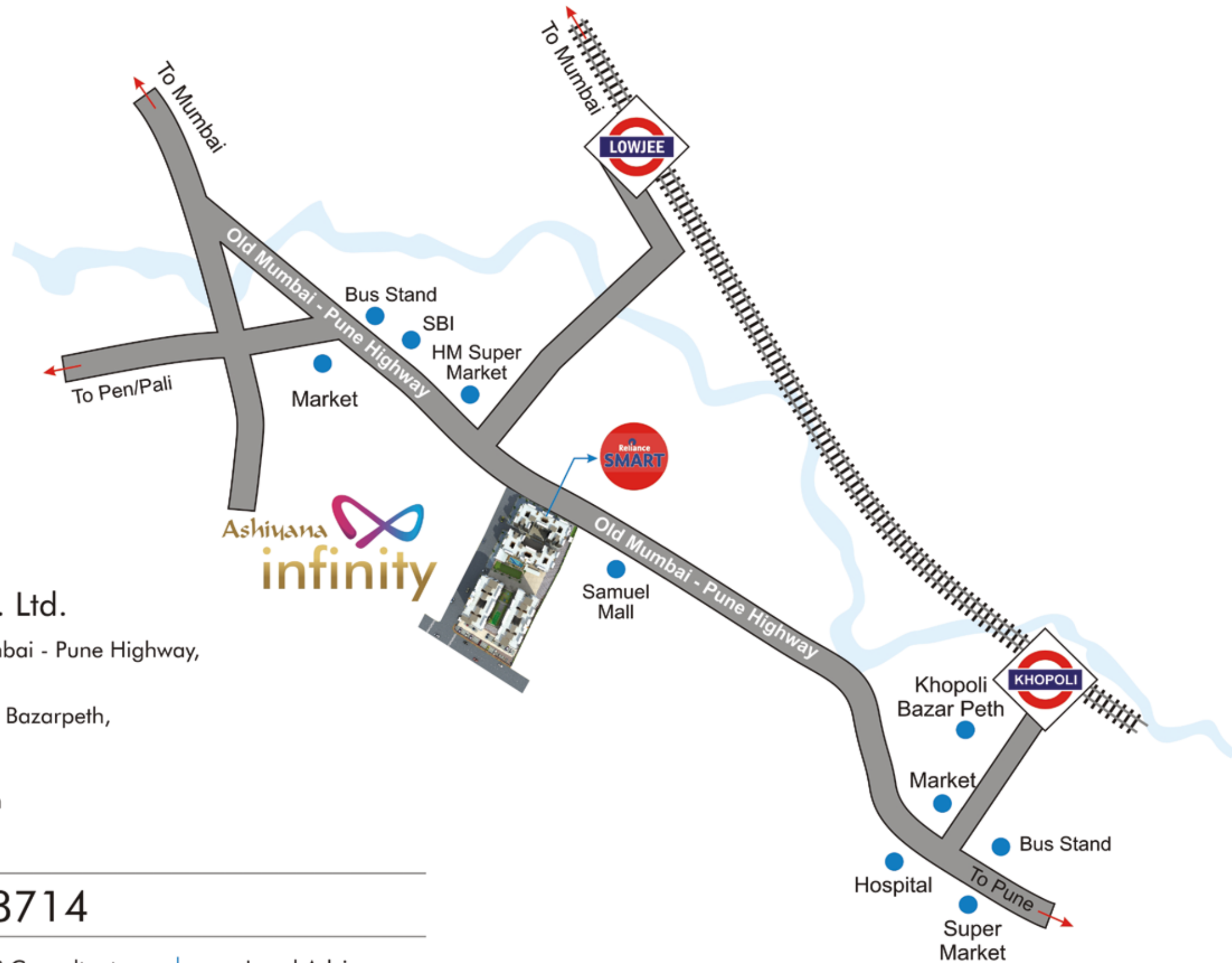

**Disclaimer** The contents of this brochure are purely an indication of the proposed development. They do not constitute any legal binding on the developers whatsoever. In compliance with the future directives by the sanctioning authorities or due to TDR related constraints or in the interest of the project execution or for enduring improvement; the developers reserve unequivocal rights at their sole discretion to amend, cancel or augment the size and the scope of layout, design, features and specifications of the proposed project and amenities; including but not limited to the construction area, open area, wings, floors, flats, podiums, parkings, brands used etc. It is explicitly understood that no claim, monetary or otherwise, can be made against the developers on the basis of the contents of this brochure.  
The furniture and other things shown in the cut view are only for representation purpose. The actual flat will be as per Specifications mentioned in the agreement.